

stern

STERN ENGINEERING LTD.



ELECTRONICLY OPERATED FOOT WASHER

FOOT WASHFREE FOOT WASHFREE 3000

INSTALLATION AND MAINTENANCE GUIDE

1	TECHNICAL DATA
2-3	PACK CONTENTS
4	PRE-INSTALLATION INFO
5-7	INSTALLATION
8-9	FLOW TIME ADJUSTMENT
9	MAINTENANCE
	Filters cleaning instructions
	Care and cleaning of chrome and special finishes
10-11	BATTERY REPLACEMENT
11	SPARE PARTS LIST
12	WARRANTY
13	TROUBLE SHOOTING

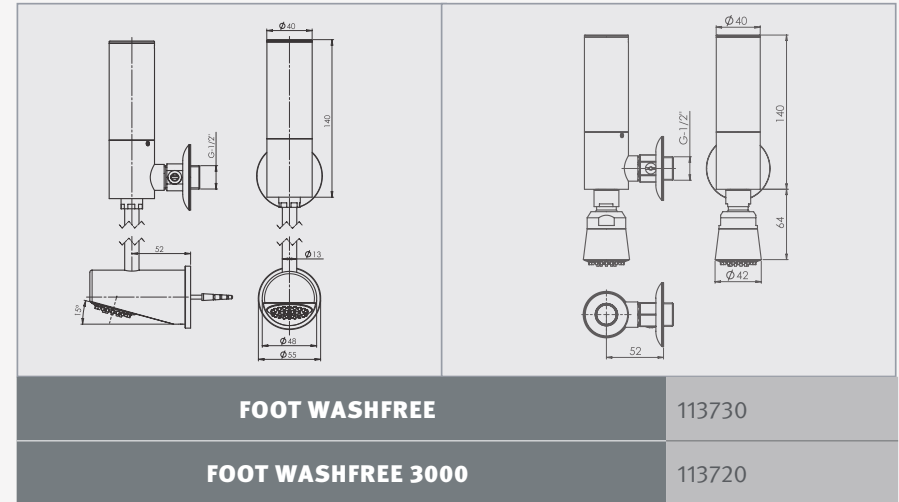

Product Control:	Touch using Piezo technology
Minimum Operating Water Pressure:	0.5 bar
Maximum Operating Water Pressure:	8.0 bar
Max. Hot Water Supply:	70° C
Power Specification:	Internally mounted 9V Lithium battery
Default Flow Time:	8 seconds. Adjustable

PACK CONTENTS

FOOT WASHFREE

Familiarize yourself with the part names and confirm that the parts are included.

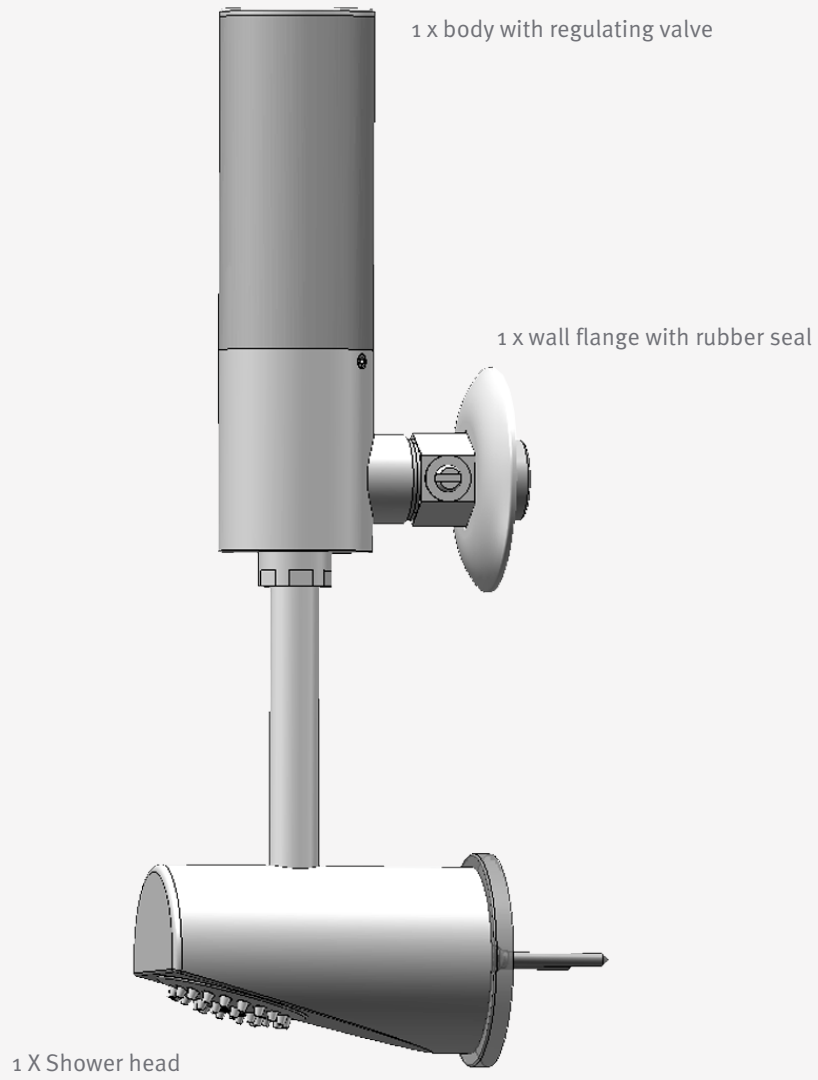

PACK CONTENTS

FOOT WASHFREE 3000

Familiarize yourself with the parts names and confirm that the parts are included.

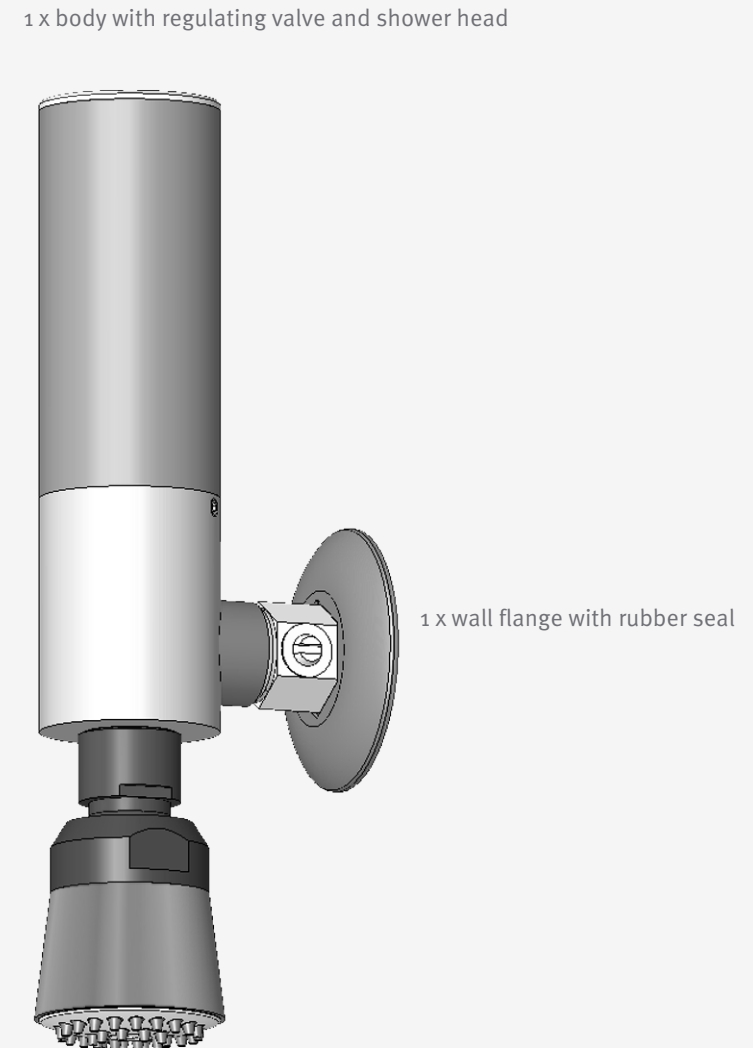

CHECK CONTENTS

Separate all parts from the packaging and check each part with the “Pack contents” section.

Pay attention to the different models variations.

Make sure all parts are accounted for before discarding any packaging material.

If any parts are missing, do not attempt to install your electronic faucet until you obtain the missing parts.

WARNINGS

Do not install facing a mirror or any other electronic system operated by an infrared sensor.

To prevent reflection problems, it is recommended to keep a minimum distance of 1.50 meters between the faucet and any other objects.

PREPARATION FOR INSTALLATION

Flush water supply lines thoroughly before installing the faucet. Do not allow dirt, Teflon tape or metal particles to enter the faucet.

Shut off water supply.

IMPORTANT

All plumbing is to be installed in accordance with applicable codes and regulations.

STEP 1- INSTALLING THE FOOT WASHER

1

Shut off the water supply.



2

Remove the hexagonal nut, the disk and the gasket. Do not remove the O-ring from the base of the faucet.

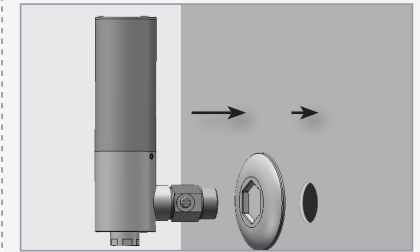

3

Place the faucet with O-ring into the hole in deck or lavatory. Make sure the O-ring is located between the deck or lavatory and the bottom of the faucet.

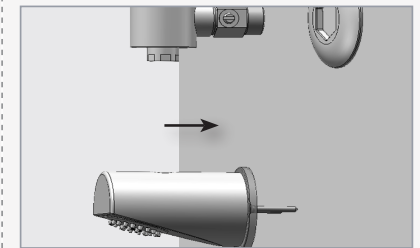

4

Slide the gasket, disk and hexagonal nut over the flexible hose and secure the faucet into place.

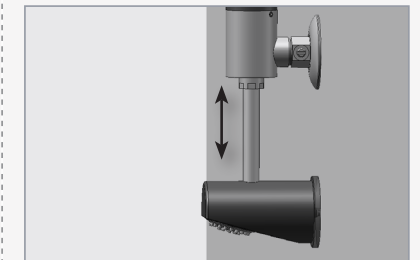

NOTE: If needed, cut the pipe to match the distance between the Alcala body and the shower head.

STEP 2 – CONNECTING THE WATER SUPPLY

1

Turn on the central water supply and the shut-off valves and check for leaks.



2

Ensure that the regulating valve is fully open by turning it anti-clockwise.

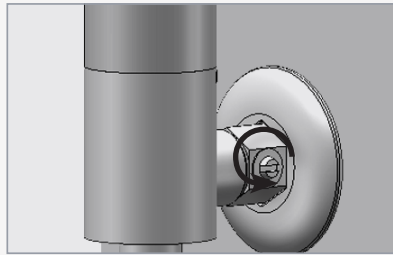

STEP 1- INSTALLING THE FOOT WASHER

1

Shut off the water supply.

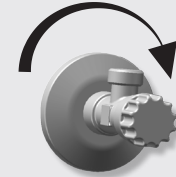

2

Install the Foot Washfree on the wall connected to the mains water supply. Use sealing thread or teflon tape to seal the screw thread connection. Fit the wall rosette between the inlet opening of the regulating valve and the surface of the wall.

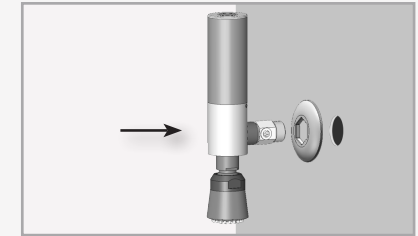

STEP 2 – CONNECTING THE WATER SUPPLY

1

Turn on the central water supply and the shut-off valves (angle valves) and check for leaks.

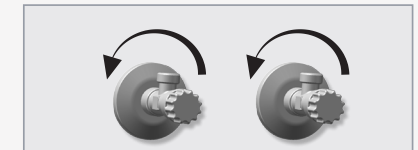

2

Ensure that the regulating valve is fully open by turning it anti-clockwise.

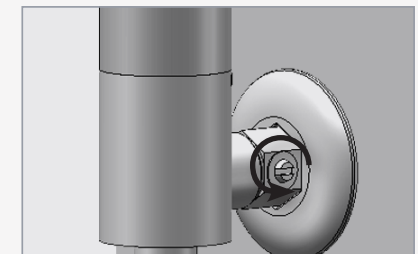

FLOW TIME ADJUSTMENT

ADJUSTMENT LEVELS

The flow time is programmable on site. If necessary, the default flow time of 8 seconds can be adjusted to any value between 1 to 60 seconds. The Alcalá adjustment mechanism is composed of 3 adjustment levels for changing the flow time. An indicator light (LED) will guide you from one level to the other.

The following table shows the number of steps in each level, the duration of each step and how to recognize in what adjusting level you are.

	Level 1	Level 2	Level 3	Out of adjusting mode
No. of steps	10 steps	10 steps	2 steps	
Seconds to be increased by touching once	1 second	2 seconds	15 seconds	
Adjustment level indicator	After entering into adjusting mode level 1 is reached	Indicator light blinks twice	Indicator light blinks 3 times	Indicator light blinks 4 times

HOW TO ADJUST THE FLOW TIME IN ALCALÁ

- 1) Open the piezo cap using the provided 2 mm Allen key.
- 2) Disconnect the internal battery.
- 3) Touch the piezo cap twice.
- 4) Then, reconnect the battery.
- 5) The indicator light (LED) on the back of the Piezo cap will start blinking. After a few blinks the LED will give a steady red light. Touch the Piezo cap when the steady red light is still on to enter into the adjusting mode. When done correctly, the light will stop blinking.

NOTE: If you will not press at the indicated area, the previous adjustment will remain.

- 6) By touching the Piezo cap the new flow time will be programmed. In adjusting mode level 1, each touch increases the flow time by 1 second with a maximum of 10 seconds. You will see the LED blinking every time that a new step is performed.
- 7) If your desired flow time is within 10 seconds, no other adjusting levels are needed and you can stop pressing the Piezo cap. The LED will blink 2 times, then 3 times and after 4 times you will leave the adjusting mode. The Foot Washfree now adjusted to the desired flow time.
- 8) If you need to perform steps at adjusting level 2, wait until you see the LED blink twice and then, perform the needed quantity of steps (with a maximum of 10 seconds of 2 seconds).

FLOW TIME ADJUSTMENT

If you do not need more levels, stop pressing. The indicator light will blink 3 times and after 4 times you will leave the adjusting mode. The Alcalá is now adjusted to the desired flow time.

9) If you need to perform steps at adjusting level 3, wait until you see the LED blink 3 times and then, perform the needed quantity of steps (with a maximum of 2 steps of 15 seconds).

10) To leave the adjusting mode wait until the LED blinks 4 times. The Foot Washfree now adjusted to the desired flow time.

MAINTENANCE

FILTER CLEANING INSTRUCTIONS

The system is provided with two stainless steel filters preventing foreign particles to enter the lines. If the water flow has decreased, this may be because the filters are clogged. The filters can be cleaned as follows:

1. Shut-off the water shut off valve.
2. Disassemble the Alcalá, and remove the filter located between the body and the shut off valve.
3. Wash the filter under running water.
4. Reassemble the parts.
5. Make sure that there is no water leakage.

CARE AND CLEANING OF CHROME AND SPECIAL FINISHES

DO NOT use steel wool or cleansing agents containing alcohol, acid, abrasives, or the like. Use of any prohibited cleaning or maintenance products or substances could damage the surface of the faucet.

For surface cleaning of faucets use ONLY soap and water, then wipe dry with clean cloth or towel. When cleaning bathroom tile, the faucets should be protected from any splattering of harsh cleansers.

BATTERY REPLACEMENT

LOW BATTERY INDICATOR

Alcala has an advanced battery level management system consisting of two steps. In the first step, the battery still has enough power to open and close the solenoid valve and allows the solenoid valve to open.

In the second step the battery might not have enough power to open and close the solenoid valve. In this case, the battery level management system does not allow the solenoid valve to open. Instead of providing an opening and closing pulse, the systems provides two closing pulses.

BATTERY REPLACEMENT INSTRUCTION

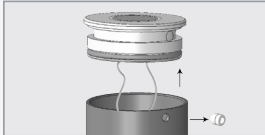
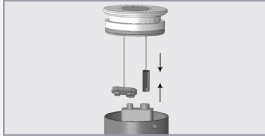
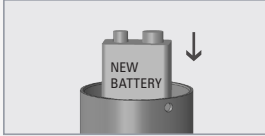
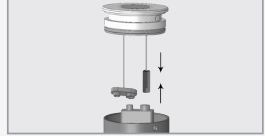
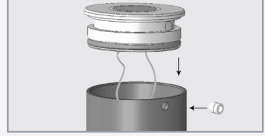
1	Unscrew the M4X4 Allen screw on the Alcala cap and pull out the piezo cap.	
2	Disconnect the connectors and take out the old battery.	
3	Replace the used battery with a new 9V battery. A lithium battery is recommended.	
4	Reconnect the connectors between the battery and Piezo cap.	
5	Place the Piezo cap back into place and tighten the Allen screw.	

NOTE:

- Do not allow moisture or water into the system while the battery is being replaced.
- The interior of the shower control must be fully dry before reassembling the parts. If it is not fully dry, carefully dry it.

SPARE PARTS LIST

FOOT WASHFREE:

SEALS AND SCREWS KIT	08530013
FILTER	07220174
COVER KIT	07270194
SOLENOID VALVE KIT	07230002
SPRAY PLATE+SCREW KIT	07212013

FOOT WASHFREE 3000:

SEALS AND SCREWS KIT	07210149
FILTER & RESTRICTOR KIT	07212009
COVER KIT	07270194
SOLENOID VALVE KIT	07230002
SPRAY PLATE+SCREW KIT	07212013

Y. Stern Engineering Ltd. warrants that its electronic faucets, flush valves and controls will be free of defects in material and workmanship during normal use for two years from the date the product is purchased.

If a defect is found in normal use, Y. Stern Engineering Ltd. will, at its discretion, repair, provide a replacement part or product, or make appropriate adjustments. Damage caused by accident, misuse, or abuse is not covered by this warranty. Improper care and cleaning will void the warranty. Proof of purchase (original sales receipt) must be provided to Stern Engineering Ltd. with all warranty claims.

Stern Engineering Ltd is not responsible for labor charges, installation, or other incidental or consequential costs other than those noted above. In no event shall the liability of Stern Engineering Ltd. exceed the purchase price of the faucet, valve or control.

If you believe that you have a warranty claim, contact your Stern Distributor, Dealer or Plumbing Contractor. Please be sure to provide all pertinent information regarding your claim, including a complete description of the problem, the product, model number, the date the product was purchased, from whom the product was purchased and the installation date. Also include your original invoice.

Y. STERN ENGINEERING AND/OR SELLER DISCLAIM ANY LIABILITY FOR SPECIAL, INCIDENTAL OR CONSEQUENTIAL DAMAGES. This warranty excludes product damage due to installation error, incorrect maintenance, wear and tear, battery, water composition, product abuse, or product misuse, whether performed by a contractor, service company, or the consumer. This warranty does not cover product damage caused by the following:

- Incorrect installation, inversions of supply pipes.
- Pressures or temperatures exceeding recommended limits.
- Improper manipulation, tampering, bad or lapsed maintenance.
- Foreign bodies, dirt or scale introduced by the water supply.

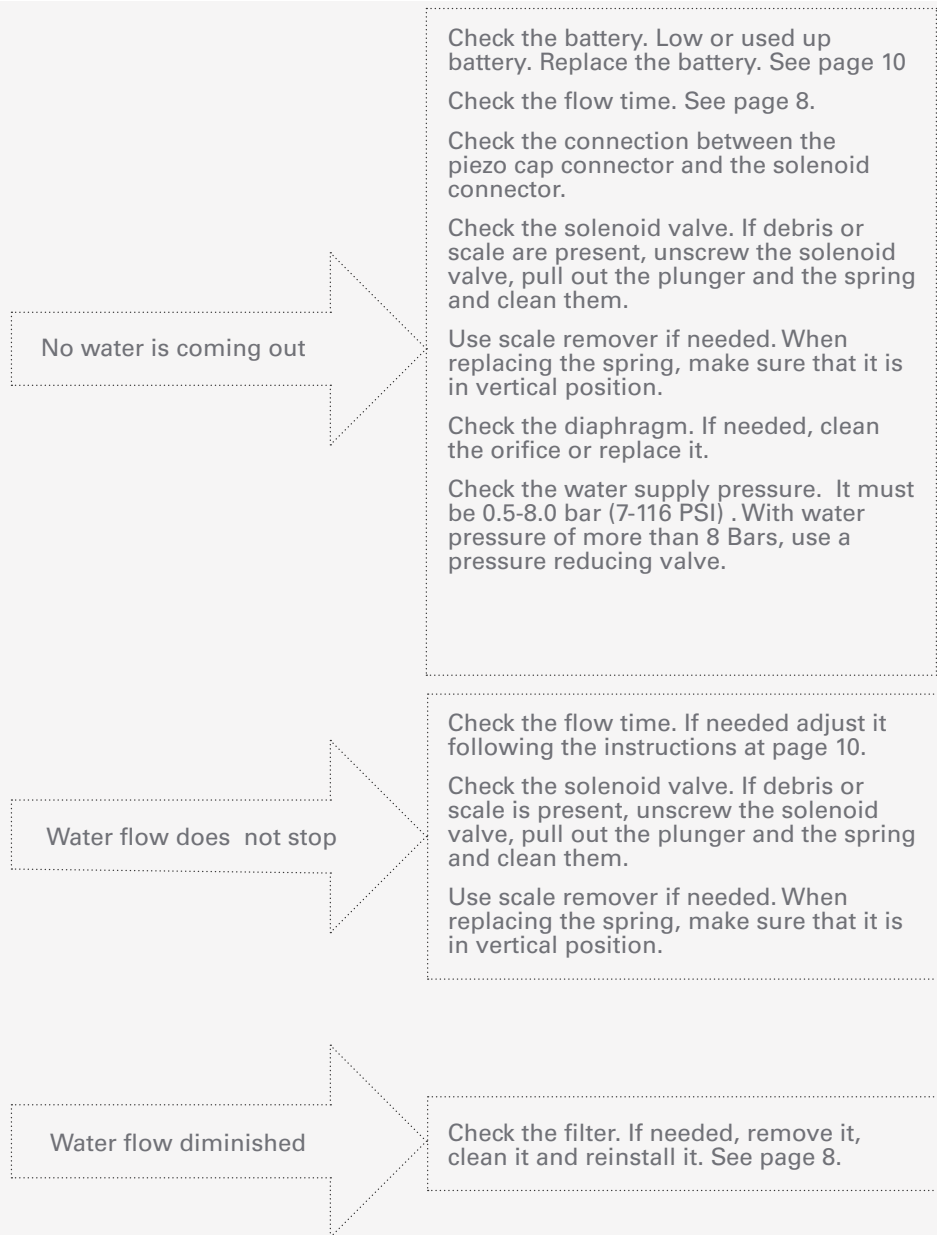

stern

STERN ENGINEERING LTD.

777 Passaic Avenue, Clifton NJ, 07012, USA
Tel: +1-973 773 8011 | Fax: +1-973-779-8768
Toll Free: 1-800-4364410
info@sternfaucets.com | sternusa@sternfaucets.com

