



ES0010C
Bright finish

General Description

- Toilet brush holder made of chrome brass bright finish.
- Suitable for wall mounting or floor standing.
- Suitable for the hotel sector, for fitting in bath hotel rooms.
- Model suitable for public use.

Components and materials

- **BODY:** made of chrome brass 1mm thick, bright finish.
- **HANDLE:** made of chrome brass 0.8mm thick, bright finish.
- **COVER:** made of AISI 430 stainless steel 0,6mm thick, bright finish.
- **BRUSH:** sisal fiber.

Technical Specifications

Dimensions	400 x 90 x 90 mm
Body thickness	1 mm
Handle thickness	0.8 mm
Cover thickness	0.6 mm

Dimensions

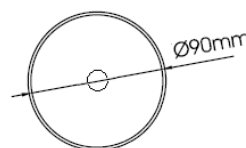
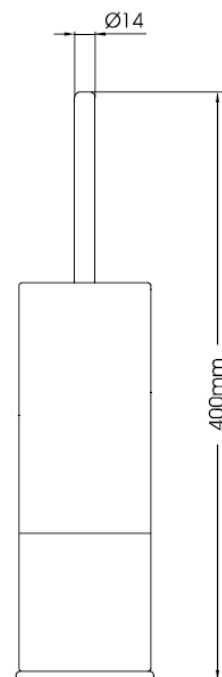

Dimensions ± 4%

MOUNTING

Fix the wall bracket to the wall using the supplied screws and taking into account the distances of the points indicated by an "S" in the following figure:

